



Innovative
Solutions & Support



3ATI Integrated Standby Unit

IS&S 3ATI Integrated Standby Unit

Technical Overview

The IS&S 3ATI Integrated Standby Unit (ISU) calculates, processes and displays altitude, attitude, airspeed, slip/skid, and navigation display information in a logical and concise single instrument display. The unit is designed to support additional enhancements for Radio Management and Alternate Navigation functionality.

The ISU incorporates an integral Inertial Measurement Unit (IMU) which includes accelerometer, gyro and magnetometer triads. The IMU is adaptable to include an integral air data module to measure static and total pressure for independent display of altitude, airspeed and Mach number. Through a proprietary algorithm, the ISU compensates for soft iron effects on the internal magnetometer.

Using an Installation Configuration Module (ICM) the ISU installation is calibrated to the specific aircraft and the ICM stores data such as static source error correction, Vmo and Mmo.

The 3ATI form factor makes the ISU ideally suited for a variety of fixed wing and rotary aircraft and the ICM is provided to support installation on a multiple airframes.

The ISU utilizes MEMS Gyro technology coupled with the unparalleled history of IS&S air data, RVSM and Flat Panel Display System (FPDS) product experience, resulting in a highly reliable and accurate standby display system for retrofit and OEM applications.

The ISU display format uses a familiar Primary Flight Display (PFD) format to enhance situational awareness and reduce pilot workload. The standby indicator's solid-state design offers increased reliability over legacy electrical mechanical instruments with savings in maintenance and logistics due to the reduction in component parts. The IS&S ISU features a high resolution LCD display with full LED backlighting improving reliability and readability to the pilot. The graphics are fully anti-aliased with unprecedented accuracy and detail. The ISU provides full sunlight readability. The display brightness adapts to the cockpit lighting conditions via an integrated ambient light sensor thereby reducing the pilot's workload.

IS&S 3ATI ISU Part Number: 9D-80196-1



IS&S 3ATI ISU replaces 2-3 standby instruments:

- Air Speed Indicator
- Altitude Indicator
- Attitude or Horizon Indicator



Features & Options

- Advanced display technology
- Versatile interface capability
- Highly accurate data sensors
- DG Mode
- Software RTCA DO-178B Level B
- Complex Electronic Hardware: RTCA DO-254 Level B
- Hardware Qualification: RTCA DO-160G
- Configurable ARINC 429 inputs
- Reduced pilot workload
- Increased safety
- Logistics and maintenance benefits by integrating multiple functions into one LRU
- Options:
 - NVIS
 - External magnetometer interface
 - Standby Radio Management Unit (RMU)
 - Alternate Navigator Functionality
 - RVSM Compliance

System Specifications

Operating Specifications

Weight: 1.9 lbs.

Dimensions: 3.26"W x 3.26"H x 7.4"D

Mounting: 3-ATI Clamp Mount
Optional Panel Mount

Power: 28 VDC, 9.8 watts

Reliability: 18,500 hours MTBF

Display: 2.38" x 2.38"

Sensors: Solid State

Qualifications: DO-160G, DO-178B
Level B, DO-254
Level B

Certifications

TSO C2d Airspeed Instruments
TSO C3e Turn and Slip
TSO C4c Bank and Pitch
TSO C6e Direction Instrument
Magnetic
TSO C8e Vertical Speed
TSO C10b Altimeter, Pressure
Actuated Sensitive
Type
TSO C34e ILS Glideslope
TSO C36e ILS Localizer
TSO C40C VOR Receiving
Equipment
TSO C46A Max Allowable
Airspeed Indicator
TSO C66C Distance Measuring
Equipment
TSO C95a Mach Meters
TSO C106 Air Data Computer
TSO C113a Airborne
Multipurpose
Displays
TSO C201 Attitude and Heading
Reference System

Signal Inputs/Outputs

RS422 / 232 : 3 Channels Input / Output

ARINC 429: 6 inputs
(Configurable for VOR, ILS, DME, FMS, GPS)
2 Outputs, High Speed / Low Speed SW Configurable
2 outputs (Configurable)

Analog: 3 DC Inputs (ILS/ GS duration, TAT probe)

Discrettes: 5 configurable input discrettes

1 configurable output discrete

Outline Dimensions

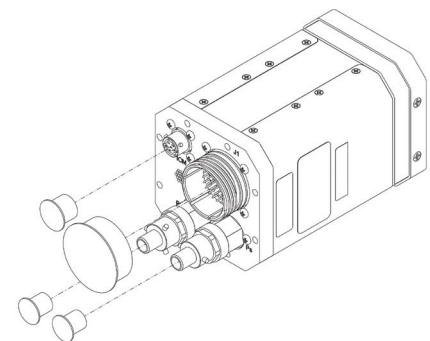
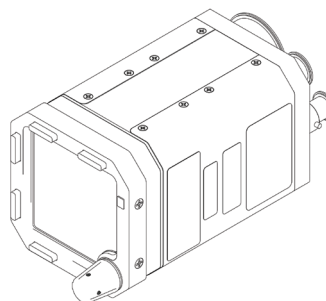
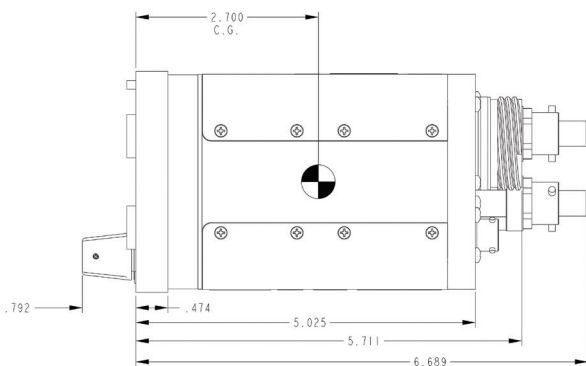
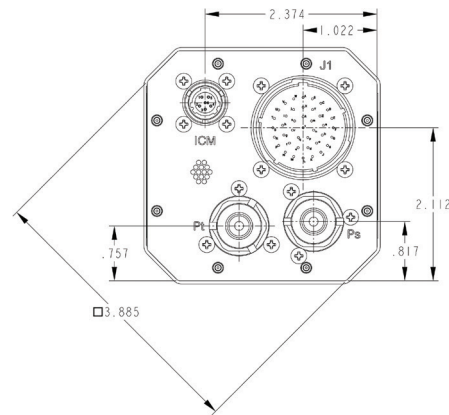
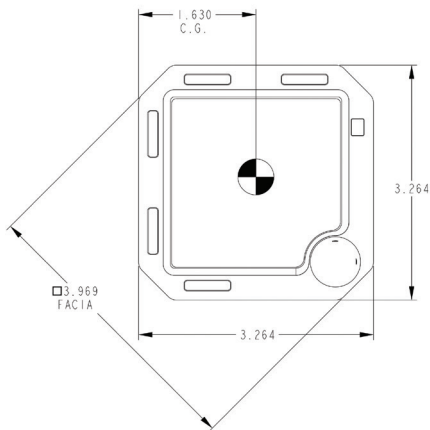

Performance

Altitude Range: -1000 to 55,000 ft, (-300 to + 16,760 M)

Altitude Scale Error:	0 ft	±20 ft
	1000 ft	±20 ft
	2000 ft	±25 ft
	3000 ft	±25 ft
	4000 ft	±25 ft
	5000 ft	±25 ft
	8000 ft	±30 ft
	11000 ft	±35 ft
	14000 ft	±40 ft
	17000 ft	±45 ft
	20000 ft	±50 ft
	30000 ft	±75 ft
	40000 ft	±100 ft
	50000 ft	±125 ft

Airspeed Range: 40 to 500 knots

Airspeed Scale Error:	40 Kts - 60 Kts	±4 Kts
	70 Kts - 500Kts	±2 Kts

Pitch Range:	±90 Degrees	Pitch/ Roll Range:	300 Degrees/Second
Roll Range:	±180 Degrees	Baro Setting Input Range:	22.00 to 32.00 InHg (745 to 1084 MB)
Pitch/ Roll Accuracy:	±0.5 Degrees	Brightness:	0.1 – 140 Foot Lamberts, Dimmable
		Viewing Angle:	±45 Degrees

Data Sheet and all information contained in it is proprietary to Innovative Solutions & Support, Inc.
All specifications are subject to change without notice from manufacturer.

IS&S is the world's leading supplier of RVSM systems and integrator of Cockpit Information Systems (Cockpit/IP®) for the Commercial Air Transport, Military, and Business Aviation Markets. IS&S incorporates leading edge technologies into sophisticated, cost-effective solutions for the aerospace industry.



**Innovative
Solutions & Support**

Corporate Headquarters:
720 Pennsylvania Drive
Exton, PA 19341 USA
+1 610 646 9800 phone
+1 610 646 0146 fax
www.innovative-ss.com

IS&S products identified in this document are covered by one or more Patents identified on innovative-ss.com

